

REVISION HISTORY				
REV.	ECO#	DESCRIPTION	DATE	BY
1		ORIGINAL RELEASE	10/21/2009	KAH

Part 1 ©ER-1-01-00335-Customer 1

B

A

FORM: TITLE BLOCK REV. A

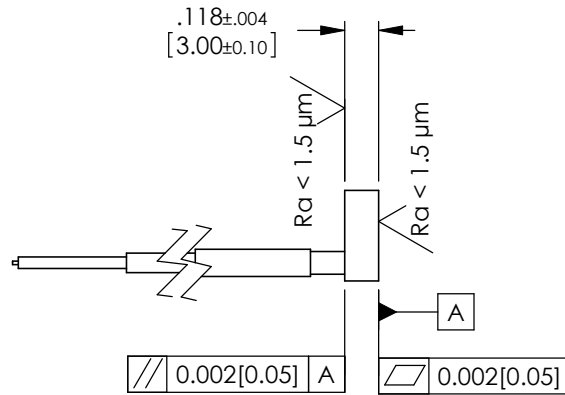
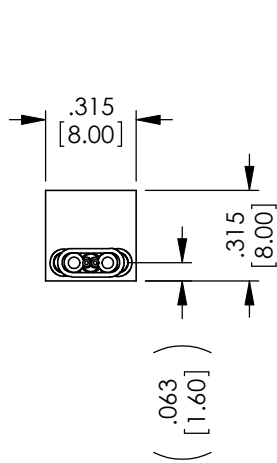

2X 20 AWG SPC 200°C
TEFLON INSULATED LEADS

28 AWG TYPE K 200°C TEFLON
INSULATED THERMOCOUPLE

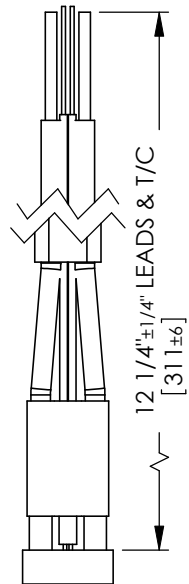
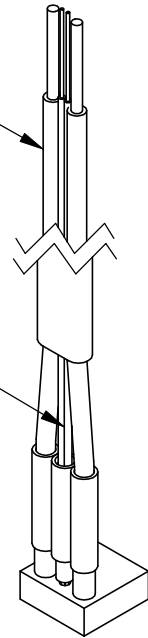

NOTES:

1. VOLTAGE: 12 VOLTS
2. POWER: 21.6 WATTS (NOMINAL) AT 25°C.
3. RESISTANCE: 6.67 ± 1.67 OHMS AT 25°C.
4. TCR: .00150 ± .00025 /°C.
5. MAXIMUM TEMPERATURE: 400°C.

UNLESS OTHERWISE SPECIFIED, DIMENSIONS ARE IN INCHES & [MILLIMETERS] PER ASME Y14.5M-1994. TOLERANCES: FRACTIONS ±1/16" X ±.01"	DWN:	KAH	10/21/09		909 Horan Drive Fenton, MO 63026 Phone 636-349-5123 Fax 636-349-5352	
	CHK:					
.XX ± 0.01" & [.X] ± 0.3mm .XXX ± 0.005" & [.XX] ± 0.13mm .XXXX ± 0.0005" & [.XXX] ± 0.013mm ANGLES ±0.5°	ENG:			WATLOW TITLE ULTRAMIC 600 ADVANCED CERAMIC HEATER CUSTOMER		
	MFG:					
CONFIDENTIAL: This drawing and all information associated therewith may contain the confidential information of Watlow, or its customers or suppliers, which is subject to patent, trademark, copyright, or trade secret protection. Neither this drawing or the information associated therewith should be reproduced, used, or disclosed to others without the prior written permission of Watlow. Copyright 2004 Watlow Electric Manufacturing Co. All rights reserved.	QA:			SIZE	DWG. NO.	REV
	PUR:			A	CER-1-01-00335-Customer	1
FINISH	THIRD ANGLE PROJECTION		CAD/REF. NO.	SCALE	WEIGHT	SHEET
MATERIAL AIN			CER-1-01-00335	1.5:1		1 OF 1
CUSTOMER WATLOW SALES						